

SY-E35° (Outdoor) Construction Schematic

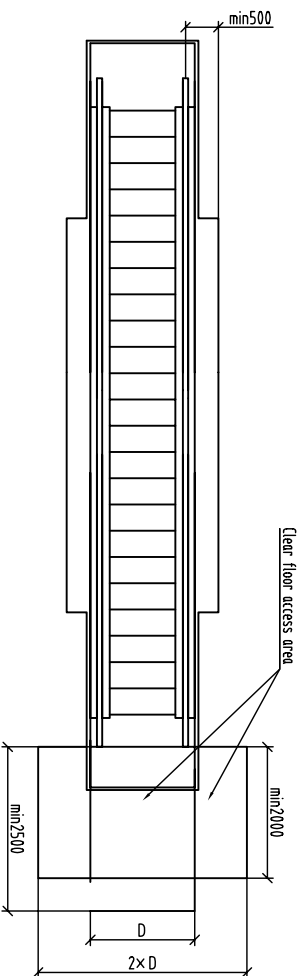

DETAIL 1

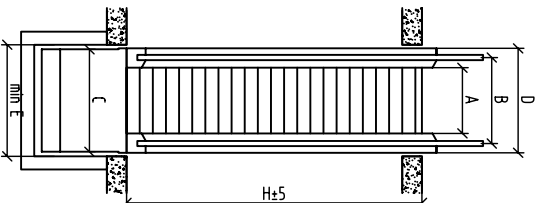
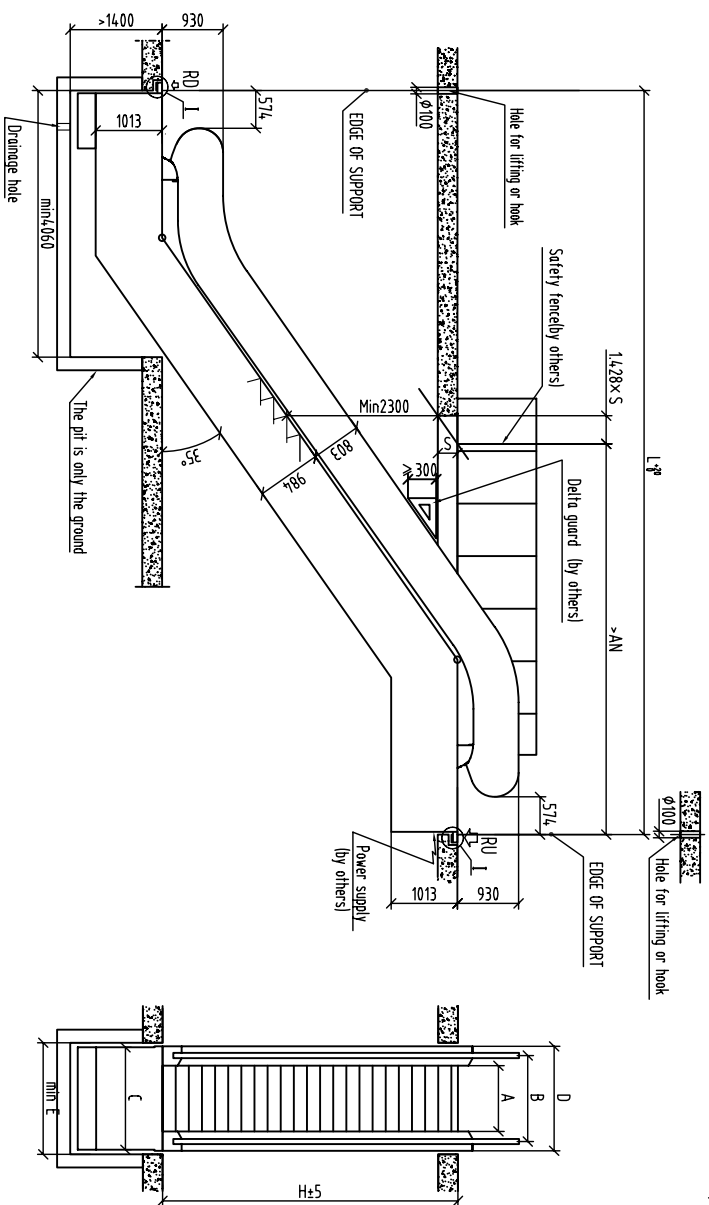
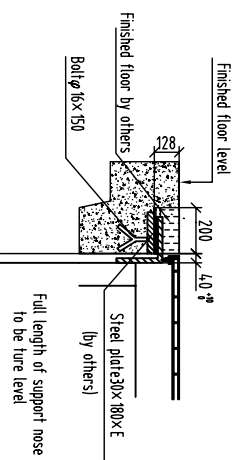

TASKS FOR OWNERS AND CIVIL CONTRACTORS

1. This drawing is applicable to single unit escalator civil engineering construction which rise is ≤ 6m.
2. Before installation, all holes in shaft must mount safetyguard which height is not less than 1.2m • and guarantee enough safe fence.
3. Pit should be water-proof. The location of push should be at the wall corner.
4. Give power to machine room and setup protective switch. The power fluctant range should be less than ±7%. The N wire and earth wire should be separated and the ground resistance is not more than 4 Ω.
5. If the distance is less than 500mm between handrail center line and any barrier, the user should make a vertical anti-strike board which has no sharp edges on top of our cladding. Its height should not less than 300mm.
6. If the user have any special request, they should make contract after confirmation from manufacturer technical department.

MACHINE Type	MOTOR Power (KW)	Maximum lifting height step width			
F160	7.5	1000	800	600	600
(RM160)	9.5/9	6.0	---	---	---

Angle α	Speed (m/s)	Rising height (mm)	Step width A (mm)	Span L (mm)	其它尺寸(mm)					本系列(KW)	
					AN	B	C	D	E	RU	RD
35°	0.5	H≤6000	1000	1428H+4905	5950	1237	1500	1530	1640	5.11+13	5.11+5
					800	1037	1300	1330	1440	4.41+15	4.41+9
					600	1428H+5405	6450	837	1100	1130	1240