

SY-E30° (Outdoor) Construction Schematic

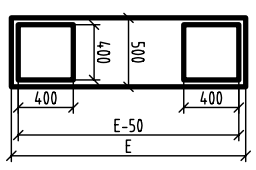
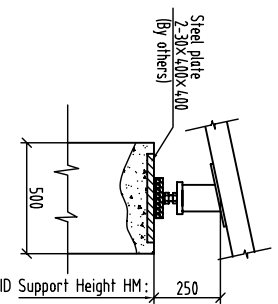
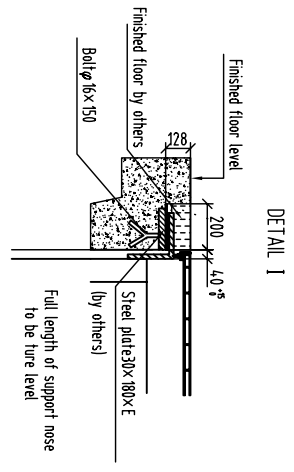
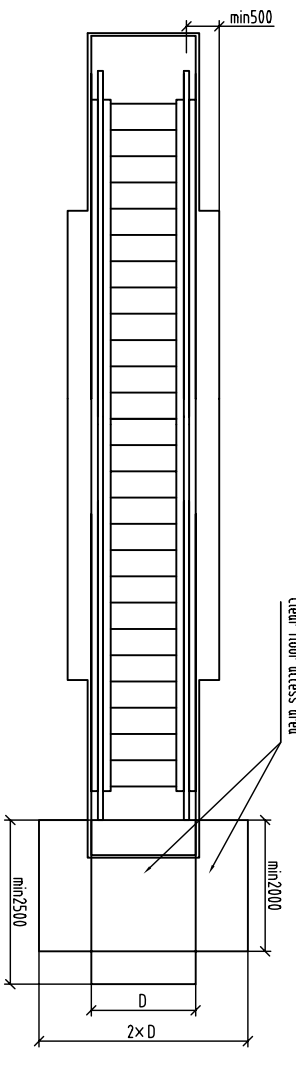
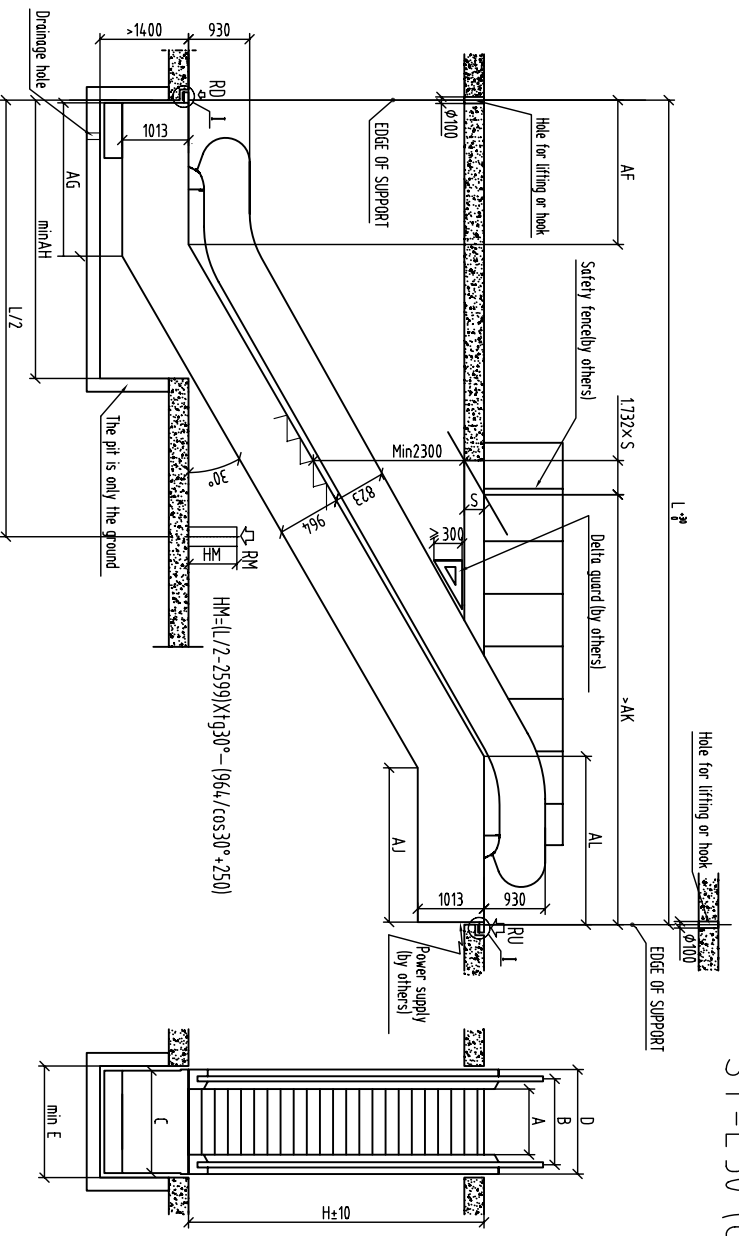

- ### TASKS FOR OWNERS AND CIVIL CONTRACTORS
- This drawing is applicable to single unit escalator/civil engineering construction which rise is $3m \leq H \leq 8m$. (If $H > 8m$, please contact with the manufacturer's technical department.)
 - When leveling span $L > 5.3m$, there should be one support in center.
 - Before installation, all holes in shaft must mount safetyguard which height is not less than 1.2m and guarantee enough safe fence.
 - Pit should be water-proof. The location of push should be at the wall corner.
 - Give power to machine room and setup protective switch. The power fluctant range should be less than $\pm 7\%$. The N wire and earth wire should be separated and the ground resistance is not more than 4Ω .
 - If the distance is less than 500mm between handrail center line and any barrier, the user should make a vertical anti-strike board which has no sharp edges on top of our cladding. Its height should not less than 300mm.
 - If the user have any special request, they should make contract offer confirmation from manufacturer technical department.

MACHINE Type	MOTOR Power (KW)	Maximum lifting height			STEP Wdth	Supporting Reaction Forces(KN)						
		step width	800	600		2 supports	3 supports	4 supports	5 supports	6 supports	7 supports	
E160	9.5/9	7.5	4.7	6	1000	RU= 4.96L+17	RU= 2.31+13.6	RU= 4.96L+10	RU= 2.31+7.1	RM= 7.16L+4.9	RU= 2.02L+13.2	RM= 6.31L+4.8
		6.0	7.6	---	800	RU= 4.31L+18	RU= 2.02L+6.8	RU= 4.31L+10	RU= 2.02L+6.8	RM= 6.31L+4.8	RM= 6.31L+4.8	RM= 6.31L+4.8
CPW60	11	6.9	9	---	800	RU= 4.31L+10	RU= 2.02L+6.8	RU= 4.31L+10	RU= 2.02L+6.8	RM= 6.31L+4.8	RM= 6.31L+4.8	RM= 6.31L+4.8
13	8.3	---	---	---	600	RU= 3.66L+27	RU= 3.66L+22	RU= 3.66L+22	RU= 3.66L+22	RM= 6.31L+4.8	RM= 6.31L+4.8	RM= 6.31L+4.8

Note: The altitude of over 1000m and the environment temperature is higher than 35 degrees must be in accordance reduction factor calculation (Specifically determined by the manufacturer)

Angle α	Speed (m/s)	Flat Step Raising Height H (mm)	Span L (mm)	Step width A (mm)	Others(Lmm)											
					B	C	D	E	AF	AG	AH	AJ	AK	AL		
30°	0.5	2	3000 \leq H \leq 6000	1732H+4765	1000	1237	1500	1530	1640	2344	655	2756	2844	705	3106	
			1732H+5265	600	837	1100	1130	1240	2844	705	3106	2844	705	3106		
			6000 < H \leq 8000	1732H+5565	1000	1237	1500	1530	1640	2344	655	2756	2844	705	3106	
			1732H+5565	800	1037	1300	1330	1440	2344	655	2756	2844	705	3106		